

Frank Zulski
Wade Williams
Jim Kargol
Brent Shank, PE
Engineer-Manager
Lisa Kleeman
Finance Director

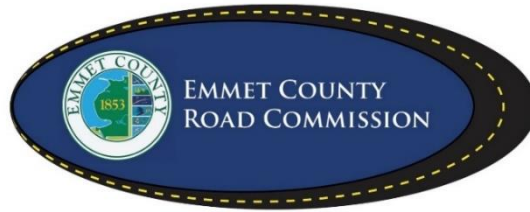

2265 E. Hathaway Road
Harbor Springs, MI 49740
Office: (231) 347-8142
Fax: (231) 347-5787
www.emmetcrc.org

Project: G47 – Middle Village Drive Gravel Supply

0.51 miles of Aggregate surface course supply and delivery to job location.

The Emmet County Road Commission will accept Bids until **9:00 a.m.** local time on **February 18, 2025** at: 2265 E. Hathaway Road, Harbor Springs, MI 49740. Bid packages are available at the Emmet County Road Commission Office or on Emmet County Road Commission website at www.emmetcrc.org.

ALL BIDS WILL BE SEALED AND PLAINLY MARKED AS TO THE PROJECT AND PROJECT NUMBER. MAILED BIDS MUST BE RECEIVED BY 3:30 P.M. THE PREVIOUS EMMET COUNTY ROAD COMMISSION BUSINESS DAY PRIOR TO BID OPENING.

The bidder has examined the plans, specification, special provisions and related materials in the proposal, as well as the location of the work described in the proposal for this project, and is fully informed as to the nature of the work and conditions relating to its performance and understands that the quantities shown are approximate only and are subject to either increase or decrease.

The bidder hereby proposes to furnish all necessary machinery, tools, apparatus and other means of construction, do all the work, furnish all the materials except as otherwise specified and, or each unit price, lump sum, or one each named in the itemized bid, to complete the work in strict conformity with the plans therefore and the entire proposal which is incorporated by reference in these pages, and in strict conformity with the requirements of the 2020 Standard Specifications for Construction, Michigan Department of Transportation and such other special provisions and supplemental specifications as may be part of the proposal for this project.

The bidder further proposes to do such extra work as may be authorized by the Emmet County Road Commission, prices for which are not included in the itemized bid. Compensation shall be made on the basis agreed upon before such extra work is begun.

THE BIDDER UNDERSTANDS AND AGREES THAT THE EMMET COUNTY ROAD COMMISSION RESERVES THE RIGHT TO REJECT ANY AND ALL BIDS; TO WAIVE IRREGULARITIES OR INFORMALITIES; AND NO CONTRACTUAL RELATIONSHIP SHALL EXIST BETWEEN THE BIDDER AND THE EMMET COUNTY ROAD COMMISSION FOR THE WORK DESCRIBED HEREIN UNTIL SUCH TIME AS THE CONTRACT HAS BEEN FORMALLY EXECUTED BY BOTH THE BIDDER AND THE EMMET COUNTY ROAD COMMISSION.

The Emmet County Road Commission, in accordance with Title VI of the Civil Rights Act of 1964, 78 Stat. 252, 42 U.S.C 2000d to 2000d-4 and Title 49, Code of Federal Regulations, Department of Transportation, Subtitle A, Office the Secretary, Part 21, Nondiscrimination in Federally assisted programs of the Department of Transportation issued pursuant to such Act, hereby notifies all bidders that it will affirmatively insure that in any contact entered into pursuant to this advertisement, minority business enterprises will be afforded full opportunity to submit bids in response to this invitation and will not be discriminated against on the grounds of race, color, or national origin in consideration for an award.

EMMET COUNTY ROAD COMMISSION

IN COOPERATION WITH

FRIENDSHIP TOWNSHIP

PLANS OF PROPOSED ROAD IMPROVEMENTS

MIDDLE VILLAGE DRIVE STATE ROAD TO CETAS ROAD

SECTION 2 T 36 N, R 6 W
FRIENDSHIP TOWNSHIP
EMMET COUNTY, MICHIGAN

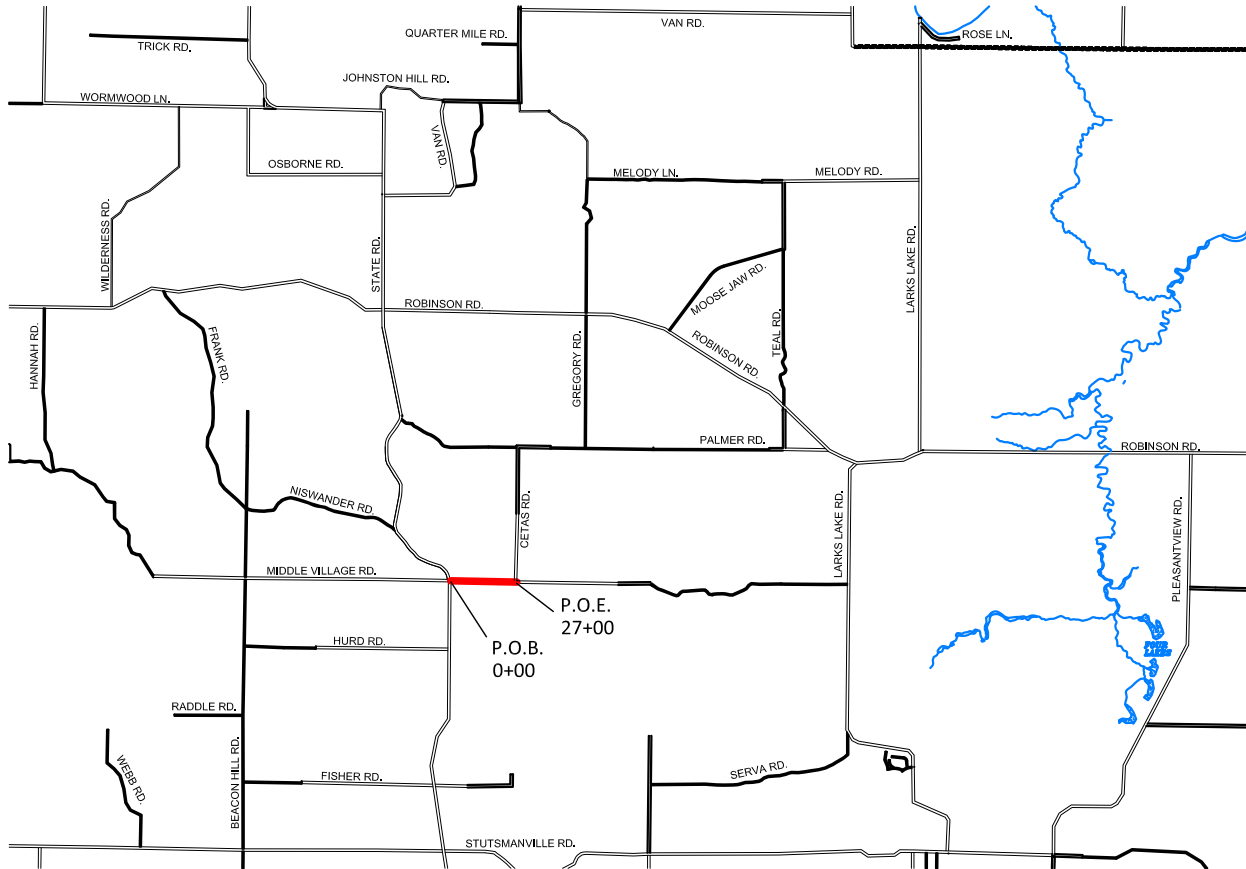

800-482-7171

CONTRACT FOR:
0.51 MILES OF AGGREGATE SURFACE COURSE SUPPLY AND DELIVERY TO JOB LOCATION.

EXCEPT WHERE OTHERWISE NOTED IN THESE PLANS, PROPOSAL, SUPPLEMENTAL SPECIFICATIONS OR SPECIAL PROVISIONS, ALL MATERIALS AND WORKMANSHIP SHALL BE IN ACCORDANCE WITH THE MICHIGAN DEPARTMENT OF TRANSPORTATION 2020 STANDARD SPECIFICATIONS FOR CONSTRUCTION.

EMMET COUNTY ROAD COMMISSION
2265 EAST HATHAWAY ROAD - HARBOR SPRINGS, MI

DESCRIPTION OF WORK

0.51 miles of Aggregate surface course supply and delivery to job location.

SPECIFICATIONS

The improvements covered by these plans shall be done in accordance with the Michigan Department of Transportation 2020 Standard Specifications for Construction as amended by Supplemental Specifications and Special Provisions.

PROJECT DATES

Project Start Date: 10 days after all Contracts are executed.
Project Completion Date: June 13, 2025

The project shall be completed within three (3) days of the starting date.

PROJECT COORDINATION

The Contractor shall coordinate all work with Emmet County Road Commission Engineer Technician, Travis L. Horrocks. Contractor shall notify the Engineer Technician a minimum of 3 calendar days prior to work starting.

PROJECT STATIONS

Station	Notes
0+00	P.O.B. - Edge of pavement at State Road.
26+22	Centerline Cetas Road.
27+00	P.O.E.

MAINTAINING TRAFFIC

The Emmet County Road Commission will provide traffic control for the project. Gravel delivery shall be scheduled for Monday – Thursday between 7AM – 3PM.

PROPOSED IMPROVEMENTS**Aggregate Surface Course**

Aggregate Surface, Cse shall meet MDOT specifications. The Contractor shall provide a scale ticket for each load delivered to the job. All scale tickets shall meet MDOT requirements. The Contractor shall provide current scale certification to the Road Commission prior to hauling material. Loader scales will not be accepted.

Aggregate Surface, Cse material shall be a 100% crushed limestone Dense-Graded Aggregate 23A or 23AA.

- The Contractor shall ensure that an adequate number of trucks are available to provide a minimum delivery rate of 200 tons per hour.
- The last load must be delivered to Middle Village Drive by 3:00 pm each day (Monday thru Thursday).

Item	Quantity	Unit
Aggregate Surface, Cse	2825	Ton

GENERAL NOTES

All work being performed will be conducted in the safest manner possible and the appropriate PPE shall be used at all times. All work shall be done in accordance with the Michigan Department of Transportation 2020 Standard Specification for Construction. Contractor assumes all responsibilities for Quality Control (QC) to assure the plans and specifications are met per the contract and to provide professional craftsmanship in each task being performed. Any errors in plans or discrepancies found in the field shall be brought to the engineer's attention immediately. All materials shall meet the requirements of the Michigan Department of Transportation Materials Source Guide.

The Emmet County Road Commission, in accordance with Title VI of the Civil Rights Act of 1964, 78 Stat. 252, 42 U.S.C 2000d to 2000d-4 and Title 49, Code of Federal Regulations, Department of Transportation, Subtitle A, Office the Secretary, Part 21, Nondiscrimination in Federally assisted programs of the Department of Transportation issued pursuant to such Act, hereby notifies all bidders that it will affirmatively insure that in any contact entered into pursuant to this advertisement, minority business enterprises will be afforded full opportunity to submit bids in response to this invitation and will not be discriminated against on the grounds of race, color, or national origin in consideration for an award.

Insurance requirements

The Contractor shall furnish proof of general liability insurance in amounts not less than \$2,000,000 each occurrence and general aggregate, proof of automobile liability in amounts not less than \$2,000,000 combined single limit for each accident, bodily injury per accident, and property damage per accident, and in amount not less than \$1,000,000 for bodily injury per person. Such proof of insurance shall include a valid certificate of insurance demonstrating that the Emmet County Road Commission is an additional insured party on the policy. Such insurance shall cover a period not less than the term of the project and shall provide that it cannot be cancelled without 30 days advanced written notice to the Emmet County Road Commission, by certified mail, first class, return receipt requested. The Contract/Project Agreement will be invalid if insurance expires during the authorized period of work described.

In addition to any liability or obligation by the Contractor that may otherwise exist, Contractor shall, to the fullest extent permitted by law, indemnify and hold harmless the Emmet County Road Commission and its commissioners, officers, agents and employees from and against any and all claims, actions, proceedings, liabilities, losses, and damages thereof, and any and all costs and expenses, including legal fees, associated therewith which the Emmet County Road Commission may sustain by reason of claims for or allegations of negligence or violation of the terms and conditions of the Contract/Project Agreement, arising out of the work which is subject of the Contract.

BID SHEET

Board of Emmet County Road Commissioners
 2265 East Hathaway Road
 Harbor Springs, MI 49740

The undersigned proposes to furnish any and all materials, labor, and equipment necessary for the gravel supply for Middle Village Drive as spelled out in the "Invitation to Bid" for the prices below.

The Emmet County Road Commission reserves the right to reject any and/or all bids based on what is in the best interest of Emmet County.

Contractor Name: _____

Project:
 G47- Middle Village Drive Gravel Supply

Item	Quantity	Unit	Unit Price	Total
Aggregate Surface, Cse	2825	Ton		
TOTAL PROJECT COST ESTIMATE =				

Bidder: _____ Address: _____

Signature: _____ Phone No.: _____

Printed Name: _____ Date: _____

Title: _____ Email: _____