

Frank Zulski – Chair
Mark W. Hoffman – Vice Chair
Wade Williams – Member
Brent Shank, PE
Engineer-Manager
Lisa Kleeman
Finance Director

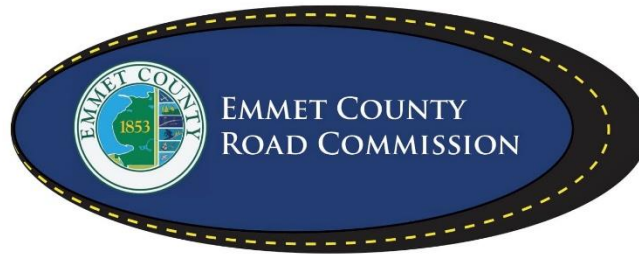

2265 E. Hathaway Road
Harbor Springs, MI 49740
Office: (231) 347-8142
Fax: (231) 347-5787
www.emmetcrc.org

PROPOSAL

Project: Van Road at Van Creek Culvert Materials

The Emmet County Road Commission will accept Bids until **9:00 a.m.** local time on **July 2, 2024** at: 2265 E. Hathaway Road, Harbor Springs, MI 49740. Bid packages are available at the Emmet County Road Commission Office or on Emmet County Road Commission website at www.emmetcrc.org.

ALL BIDS WILL BE SEALED AND PLAINLY MARKED AS TO THE PROJECT AND PROJECT NUMBER. MAILED BIDS MUST BE RECEIVED BY 3:30 P.M. THE PREVIOUS EMMET COUNTY ROAD COMMISSION BUSINESS DAY PRIOR TO BID OPENING.

The bidder has examined the plans, specification, special provisions and related materials in the proposal, as well as the location of the work described in the proposal for this project and is fully informed as to the nature of the work and conditions relating to its performance and understands that the quantities shown are approximate only and are subject to either increase or decrease.

The bidder hereby proposes to furnish all necessary machinery, tools, apparatus and other means of construction, do all the work, furnish all the materials except as otherwise specified and, or each unit price, lump sum, or one each named in the itemized bid, to complete the work in strict conformity with the plans therefore and the entire proposal which is incorporated by reference in these pages, and in strict conformity with the requirements of the 2020 Standard Specifications for Construction, Michigan Department of Transportation and such other special provisions and supplemental specifications as may be part of the proposal for this project.

The bidder further proposes to do such extra work as may be authorized by the Emmet County Road Commission, prices for which are not included in the itemized bid. Compensation shall be made on the basis agreed upon before such extra work is begun.

THE BIDDER UNDERSTANDS AND AGREES THAT THE EMMET COUNTY ROAD COMMISSION RESERVES THE RIGHT TO REJECT ANY AND ALL BIDS; TO WAIVE IRREGULARITIES OR INFORMALITIES; AND NO CONTRACTUAL RELATIONSHIP SHALL EXIST BETWEEN THE BIDDER AND THE EMMET COUNTY ROAD COMMISSION FOR THE WORK DESCRIBED HEREIN UNTIL SUCH TIME AS THE CONTRACT HAS BEEN FORMALLY EXECUTED BY BOTH THE BIDDER AND THE EMMET COUNTY ROAD COMMISSION.

The Emmet County Road Commission, in accordance with Title VI of the Civil Rights Act of 1964, 78 Stat. 252, 42 U.S.C 2000d to 2000d-4 and Title 49, Code of Federal Regulations, Department of Transportation, Subtitle A, Office the Secretary, Part 21, Nondiscrimination in Federally assisted programs of the Department of Transportation issued pursuant to such Act, hereby notifies all bidders that it will affirmatively insure that in any contact entered into pursuant to this advertisement, minority business enterprises will be afforded full opportunity to submit bids in response to this invitation and will not be discriminated against on the grounds of race, color, or national origin in consideration for an award.

Emmet County Road Commission

Van Road at Van Creek Culvert Materials

(To be completed by bidder in ink or typewritten)

Company Name: _____

Address: _____

City: _____ State: _____ Zip: _____

Phone: _____ Fax: _____

Contact Person w/Title: _____ E-Mail: _____

Van Road at Van Creek, Section 15, T37N, R4W, McKinley Township

- Main Channel: 10 foot 0 inch by 4 foot 10 inch by 60 feet long Aluminum Plate Arch Box Culvert (with bottom). Ends square, no headwalls and no wing walls (see attached plans). Plan Prints including lifting detail for crane setting this structure and all Hardware included. Cover is approximately 1.6 feet. Design for loading: HL-93.

Specify Thickness: _____ Specify Manufacture: _____

\$ _____ Lead Time: _____

Notes:

- All materials shall be labeled.
- Attached is the ELGE Permit for the site.
- We are currently anticipating a construction schedule: Fall 2024
- All prices shall be F.O.B. to Emmet County Road Commission garage at 2265 E. Hathaway Road, Harbor Springs, MI 49740. ECRC will unload materials from delivery vehicle with a Loader or Forklift, material shall come palletized (5,000-pound maximum weight per lift).
- **All materials must meet current *MDOT Stand Specifications for Construction, 2020*.**

Allowable discounts & payment terms: _____

Authorized Signature

Date

Printed Name



NOTICE OF AUTHORIZATION

Permit Number: WRP041632 v. 1
Site Name: 24 - Van Road at Van Creek

Date Issued: June 11, 2024
Expiration Date: June 11, 2029

The Michigan Department of Environment, Great Lakes, and Energy (EGLE), Water Resources Division, P.O. Box 30458, Lansing, Michigan 48909-7958, under provisions of the Natural Resources and Environmental Protection Act, 1994 PA 451, as amended: specifically:

- Part 31, Floodplain Regulatory Authority of the Water Resources Protection.
- Part 301, Inland Lakes, and Streams.
- Part 303, Wetlands Protection.
- Part 315, Dam Safety.
- Part 323, Shorelands Protection and Management.
- Part 325, Great Lakes Submerged Lands.
- Part 353, Sand Dunes Protection and Management.

Authorized activity:

Remove the three existing 60-foot long by 3-foot span by 3-foot rise corrugated metal pipe culverts and construct a single 60-foot long by 10-foot span by 4.83-foot rise aluminum multi-plate arch culvert. Install 11-cubic yards of riprap below the 100-year floodplain elevation.

To be conducted at property located in: Emmet County, Waterbody: Van Creek
Section 22, Town 37N, Range 04W, McKinley Township

Permittee:

Travis Horrocks
Emmet County Road Commission
2265 East Hathaway Road
Harbor Springs, Michigan 49740

Issued By: 
Luke Golden
Cadillac District Office
Water Resources Division
989-370-1569

*This notice must be displayed at the site of work.
Laminating this notice or utilizing sheet protectors is recommended.*
Please refer to the above permit number with any questions or concerns.

EGLE
WRP041632 v1.0
Approved
Issued On:06/11/2024
Expires On:06/11/2029



**MICHIGAN DEPARTMENT OF ENVIRONMENT, GREAT LAKES, AND ENERGY
WATER RESOURCES DIVISION PERMIT**

Issued To:

**Travis Horrocks
Emmet County Road Commission
2265 East Hathaway Road
Harbor Springs, Michigan 49740**

Permit No: WRP041632 v.1
Submission No.: HQ3-FGQZ-RP0WR
Site Name: 24 - Van Road at Van Creek
Issued: June 11, 2024
Revised:
Expires: June 11, 2029

This permit is being issued by the Michigan Department of Environment, Great Lakes, and Energy (EGLE), Water Resources Division (WRD), under the provisions of the Natural Resources and Environmental Protection Act, 1994 PA 451, as amended (NREPA); specifically:

- Part 301, Inland Lakes and Streams
- Part 303, Wetlands Protection
- Part 315, Dam Safety
- Part 31, Water Resources Protection (Floodplain Regulatory Authority)
- Part 323, Shorelands Protection and Management
- Part 325, Great Lakes Submerged Lands
- Part 353, Sand Dunes Protection and Management

EGLE certifies that the activities authorized under this permit are in compliance with the State Coastal Zone Management Program and certifies without conditions under the Federal Clean Water Act, Section 401 that the discharge from the activities authorized under this permit will comply with Michigan's water quality requirements in Part 31, Water Resources Protection, of the NREPA and associated administrative rules, where applicable.

Permission is hereby granted, based on permittee assurance of adherence to State of Michigan requirements and permit conditions, to:

Authorized Activity:

Remove the three existing 60-foot long by 3-foot span by 3-foot rise corrugated metal pipe culverts and construct a single 60-foot long by 10-foot span by 4.83-foot rise aluminum multi-plate arch culvert. Install 11-cubic yards of riprap below the 100-year floodplain elevation.

Waterbody Affected: Van Creek
Property Location: Emmet County, Mckinley Township, Town/Range/Section 37N/04W/22
Property Tax No.

Authority granted by this permit is subject to the following limitations:

- A. Initiation of any work on the permitted project confirms the permittee's acceptance and agreement to comply with all terms and conditions of this permit.
- B. The permittee, in exercising the authority granted by this permit, shall not cause unlawful pollution as defined by Part 31 of the NREPA.
- C. This permit shall be kept at the site of the work and available for inspection at all times during the duration of the project or until its date of expiration.
- D. All work shall be completed in accordance with the approved plans and specifications submitted with the application and/or plans and specifications attached to this permit.
- E. No attempt shall be made by the permittee to forbid the full and free use by the public of public waters at or adjacent to the structure or work approved.
- F. It is made a requirement of this permit that the permittee give notice to public utilities in accordance with 2013 PA 174 (Act 174) and comply with each of the requirements of Act 174.
- G. This permit does not convey property rights in either real estate or material, nor does it authorize any injury to private property or invasion of public or private rights, nor does it waive the necessity of seeking federal assent, all local permits, or complying with other state statutes.
- H. This permit does not prejudice or limit the right of a riparian owner or other person to institute proceedings in any circuit court of this state when necessary to protect his rights.
- I. Permittee shall notify EGLE within one week after the completion of the activity authorized by this permit.
- J. This permit shall not be assigned or transferred without the written approval of EGLE.
- K. Failure to comply with conditions of this permit may subject the permittee to revocation of permit and criminal and/or civil action as cited by the specific state act, federal act, and/or rule under which this permit is granted.
- L. All dredged or excavated materials shall be disposed of in an upland site (outside of floodplains, unless exempt under Part 31 of the NREPA, and wetlands).
- M. In issuing this permit, EGLE has relied on the information and data that the permittee has provided in connection with the submitted application for permit. If, subsequent to the issuance of a permit, such information and data prove to be false, incomplete, or inaccurate, EGLE may modify, revoke, or suspend the permit, in whole or in part, in accordance with the new information.
- N. The permittee shall indemnify and hold harmless the State of Michigan and its departments, agencies, officials, employees, agents, and representatives for any and all claims or causes of action arising from acts or omissions of the permittee, or employees, agents, or representative of the permittee, undertaken in connection with this permit. The permittee's obligation to indemnify the State of Michigan applies only if the state: (1) provides the permittee or its designated representative written notice of the claim or cause of action within 30 days after it is received by the state, and (2) consents to the permittee's participation in the proceeding on the claim or cause of action. It does not apply to contested case proceedings under the Administrative Procedures Act, 1969 PA 306, as amended, challenging the permit. This permit shall not be construed as an indemnity by the State of Michigan for the benefit of the permittee or any other person.
- O. Noncompliance with these terms and conditions and/or the initiation of other regulated activities not specifically authorized shall be cause for the modification, suspension, or revocation of this permit, in whole or in part. Further, EGLE may initiate criminal and/or civil proceedings as may be deemed necessary to correct project deficiencies, protect natural resource values, and secure compliance with statutes.

- P. If any change or deviation from the permitted activity becomes necessary, the permittee shall request, in writing, a revision of the permitted activity from EGLE. Such revision request shall include complete documentation supporting the modification and revised plans detailing the proposed modification. Proposed modifications must be approved, in writing, by EGLE prior to being implemented.
- Q. This permit may be transferred to another person upon written approval of EGLE. The permittee must submit a written request to EGLE to transfer the permit to the new owner. The new owner must also submit a written request to EGLE to accept transfer. The new owner must agree, in writing, to accept all conditions of the permit. A single letter signed by both parties that includes all the above information may be provided to EGLE. EGLE will review the request and, if approved, will provide written notification to the new owner.
- R. Prior to initiating permitted construction, the permittee is required to provide a copy of the permit to the contractor(s) for review. The property owner, contractor(s), and any agent involved in exercising the permit are held responsible to ensure that the project is constructed in accordance with all drawings and specifications. The contractor is required to provide a copy of the permit to all subcontractors doing work authorized by the permit.
- S. Construction must be undertaken and completed during the dry period of the wetland. If the area does not dry out, construction shall be done on equipment mats to prevent compaction of the soil.
- T. Authority granted by this permit does not waive permit requirements under Part 91, Soil Erosion and Sedimentation Control, of the NREPA, or the need to acquire applicable permits from the County Enforcing Agent (CEA).
- U. Authority granted by this permit does not waive permit requirements under the authority of Part 305, Natural Rivers, of the NREPA. A Natural Rivers Zoning Permit may be required for construction, land alteration, streambank stabilization, or vegetation removal along or near a natural river.
- V. The permittee is cautioned that grade changes resulting in increased runoff onto adjacent property is subject to civil damage litigation.
- W. Unless specifically stated in this permit, construction pads, haul roads, temporary structures, or other structural appurtenances to be placed in a wetland or on bottomland of the water body are not authorized and shall not be constructed unless authorized by a separate permit or permit revision granted in accordance with the applicable law.
- X. For projects with potential impacts to fish spawning or migration, no work shall occur within fish spawning or migration timelines (i.e., windows) unless otherwise approved in writing by the Michigan Department of Natural Resources (MDNR), Fisheries Division.
- Y. Work to be done under authority of this permit is further subject to the following special instructions and specifications:
1. All work shall be completed in accordance with plans attached; kept on file at EGLE, WRD, Transportation Review Unit.
 2. Authority granted by this permit does not waive compliance requirements under Part 91, Soil Erosion and Sedimentation Control, of the NREPA. Any discharge of sediment into waters of the state and/or off the road right-of-way is a violation of this permit, Part 91, and Part 31, Water Resources Protection, of the NREPA. A violation of these parts subjects the permittee to potential fines and penalties.
 3. This permit does not authorize or sanction work that has been completed in violation of applicable federal, state, or local statutes.

4. The permittee is responsible for acquiring all necessary easements or rights-of-way before commencing any work authorized by this permit. All construction operations relating to, or part of this project shall be confined to the existing right-of-way limits or other acquired easements.
5. Temporary soil erosion and sedimentation control measures shall be installed before or upon commencement of the earth change and shall be maintained daily. Temporary soil erosion and sedimentation control measures shall be maintained until permanent soil erosion and sedimentation control measures are in place and the area is stabilized. Permanent soil erosion and sedimentation control measures for all slopes, channels, ditches, or any disturbed area shall be installed within five (5) calendar days after final grading, or the final earth change has been completed.
6. All raw areas in uplands resulting from the permitted construction activity shall be effectively stabilized with sod and/or seed and mulch (or other technology specified by this permit or project plans) in a sufficient quantity and manner to prevent erosion and any potential siltation to surface waters or wetlands. Temporary stabilization measures shall be installed before or upon commencement of the permitted activity and shall be maintained until permanent measures are in place. Permanent measures shall be in place within five (5) days of achieving final grade.
7. All raw earth within 100 feet of a lake, stream, or wetland that is not brought to final stabilization by the end of the active growing season shall be temporarily stabilized with mulch blankets in accordance with the following dates: September 20th for the Upper Peninsula, October 1st for the Lower Peninsula north of US-10, and October 10th for the Lower Peninsula south of US-10.
8. This permit placard shall be kept posted at the work site, in a prominent location at all times for the duration of the project, or until permit expiration.
9. This permit is being issued for the maximum time allowed and no extensions of this permit will be granted. Initiation of the construction work authorized by this permit indicates the permittee's acceptance of this condition. The permit, when signed by EGLE, will be for a five-year period beginning at the date of issuance. If the project is not completed by the expiration date, a new permit must be sought.
10. All dredge/excavated spoils including organic and inorganic soils, vegetation, and other material removed shall be placed on upland (non-wetland, non-floodplain, or non-bottomland), prepared for stabilization, revegetated, and reseeded with native Michigan species appropriate to the site, and mulched in such a manner so as to prevent and ensure against erosion of any material into any waterbody, wetland, or floodplain.

11. During removal or repair of the existing structure, every precaution shall be taken to prevent debris from entering any watercourse. Any debris reaching the watercourse during the removal and/or reconstruction of the structure shall be immediately retrieved from the water. All material shall be disposed of in an acceptable manner consistent with local, state, and federal regulations.
12. Prior to the removal of the existing structures, cofferdams of steel sheet piling, gravel bags, clean stone, coarse aggregate, concrete or other acceptable barriers shall be installed to isolate all construction activity from the water. The barriers shall be maintained in good working order throughout the duration of the project. Upon project completion, the accumulated materials shall be removed and disposed of at an upland site.
13. All cofferdam and temporary steel sheet pile shall then be removed in its entirety, unless specifically shown to be left in plan on the accepted plans. Cofferdam and sheet pile that is left in place shall be cut off at the elevation shown on the plans and shall be a minimum of one foot below the stream bottom.
14. The existing structure shall be kept open to pass the stream flow during removal of the existing road fill.
15. The placement of the new culvert and the initial placement of fill in the stream shall be done immediately after removal of the existing culvert. The placement shall be conducted in such a manner that all flow is immediately passed through the new culverts, allowing the major placement of fill to be done in the dry or in still water where erosion and sedimentation will be minimized. The fill material used in this initial placement shall be washed gravel, coarse aggregate, or rock and shall be placed at both ends of the culvert to a level above normal water level before backfill material is placed.
16. The culvert shall be installed to align with the center line of the existing stream at both the inlet and outlet ends and must be **recessed into the stream bed** to provide a natural channel substrate throughout the structure, as shown on the approved plans.
17. Road fill side slopes shall not be steeper than 1-on-2 (1 vertical to 2 horizontal) except where headwalls of reinforced concrete, mortar masonry, dry masonry, or other acceptable methods are used.
18. Areas to be protected by riprap shall be cleared of brush and debris. All grades shall be shaped and compacted to the required cross section. Geotextile liner shall be placed on the prepared grades. The riprap installation shall not damage the geotextile liner.

19. Any fill shall consist of clean inert material.
20. Any alterations to the existing road grade elevations other than that shown on the plans will require prior approval from the WRD.
21. Road fill side slopes terminating in the stream and any raw streambanks resulting from the construction shall be stabilized with temporary measures in accordance with appropriate Best Management Practices based on site conditions, and if necessary, may be riprapped extending above the ordinary high-water mark, before or upon commencement of the permitted activity. Temporary stabilization measures shall be maintained until permanent measures are in place.
22. All other road fill slopes, ditches, and other raw areas draining directly to the stream may be protected with riprap, sod and/or seed and mulch as may be necessary to provide effective erosion protection. The placement of riprap shall be limited to the minimum necessary to ensure proper stabilization of the side slopes and fill in the immediate vicinity of the structure.
23. All riprap shall be properly sized and graded based on wave action and velocity and shall consist of natural field stone or rock (free of paint, soil or other fines, asphalt, soluble chemicals, or organic material). Broken concrete is allowed.
24. If the project, or any portion of the project, is stopped and lies incomplete for any length of time other than that encountered in a normal work week, every precaution shall be taken to protect the incomplete work from erosion, including the placement of temporary gravel bag riprap, temporary seed and mulch, or other acceptable temporary protection.
25. No work shall be done in the stream during periods of above-normal flows except as necessary to prevent erosion.
- 26. No work or dredging within the water authorized by this permit is allowed from March 1 to June 30 due to critical spawning, migration, and/or recreational use periods.**
- 27. Prior to the start of construction, all adjacent non-work wetland areas shall be protected by properly trenched sedimentation barrier to prevent sediment from entering the wetland. Orange construction fencing shall be installed as needed to prohibit construction personnel and equipment from entering or performing work in these areas. Fence shall be maintained daily throughout the construction process. Upon project completion, the accumulated materials shall be removed and disposed of at an upland site, the sedimentation barrier shall then be removed in its entirety and the area restored to its original configuration and cover.**

28. Stormwater shall not directly outlet to the stream.

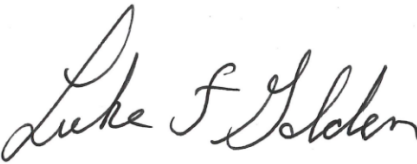
Issued By: 
 Luke Golden
 Cadillac District Office
 Water Resources Division
 989-370-1569

THIS PERMIT MUST BE SIGNED BY THE PERMITTEE TO BE VALID.

I hereby assure that I have read, am familiar with, and agree to adhere to the terms and conditions of this permit.

Permittee Signature

Date

cc: Mckinley Township Clerk
 Emmet County Drain Commissioner – VIA USPS
 Emmet County CEA

EMMET COUNTY ROAD COMMISSION
 IN COOPERATION WITH
CRA & EGLE
CULVERT PLAN VIEW
 EXISTING AND PROPOSED STRUCTURES
VAN CREEK

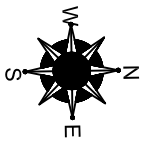
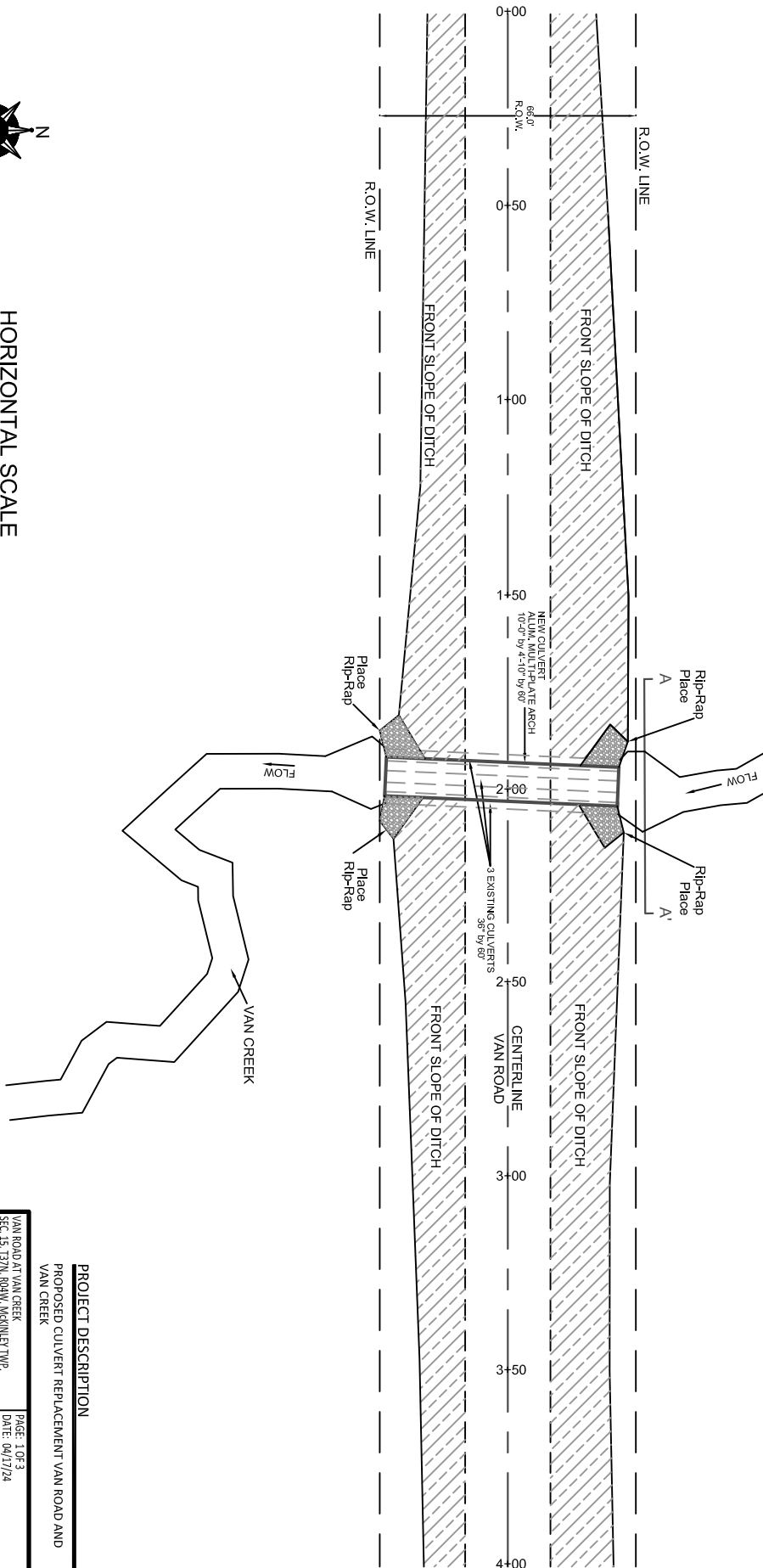

DATUM USED: WGS84

ALL DIMENSIONS IN FEET

PROJECT DESCRIPTION
 PROPOSED CULVERT REPLACEMENT VAN ROAD AND VAN CREEK

VAN ROAD AT VAN CREEK
 SEC. 15, T37N, R34W, ANKENIET TWP,
 EMMET COUNTY, MICHIGAN

PAGE: 1 OF 3
 DATE: 06/17/24
 DRAWN BY: TLH.

APPLICANT:
 EMMET COUNTY ROAD COMMISSION
 2265 E. Hathaway Road, Harbor Springs, MI 49740

EMMET COUNTY ROAD COMMISSION
 IN COOPERATION WITH
CRA & EGLE

CULVERT ELEVATION VIEW
 EXISTING AND PROPOSED STRUCTURES
 (LOOKING DOWNSTREAM/SOUTH)

STREAM PROFILE VIEW
 Existing and Proposed Structure, w/ Invert Elevations
 (LOOKING DOWNSTREAM/SOUTH)

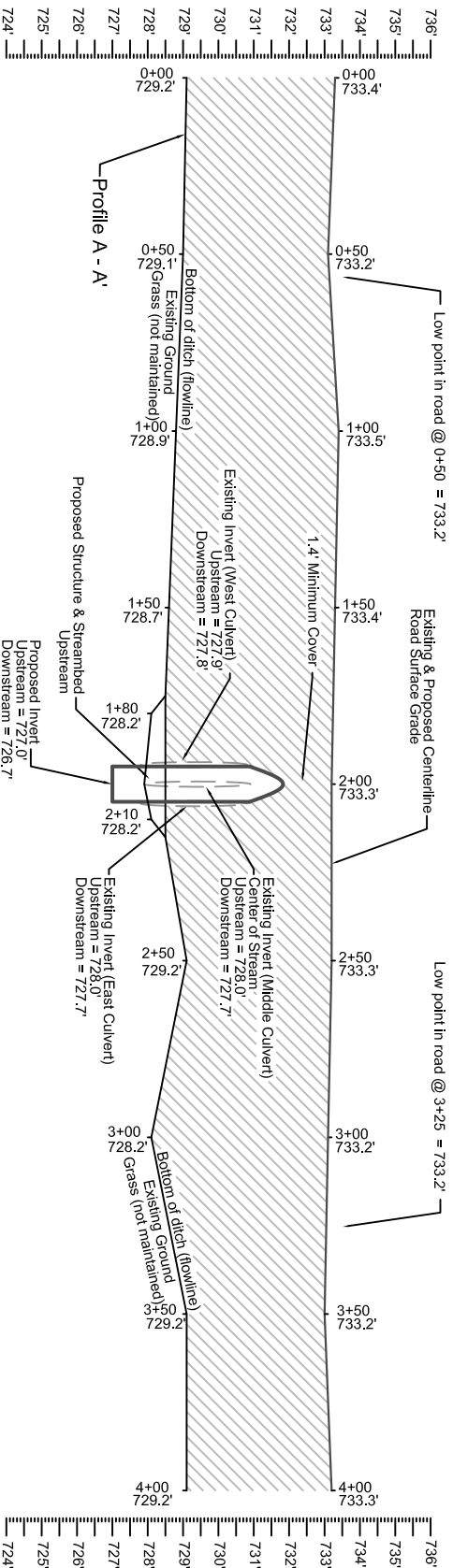

Note:
 - Field Survey 04/17/24
 - Profile A-A' taken along Ditch flowline.



PROJECT DESCRIPTION
 PROPOSED CULVERT REPLACEMENT VAN ROAD AND
 VAN CREEK

VAN ROAD AT VAN CREEK SEC. 15, T37N, R34W, N34E EMMET COUNTY, MICHIGAN	PAGE: 2 OF 3 DATE: 06/11/24 DRAWN BY: TLH.
APPLICANT: EMMET COUNTY ROAD COMMISSION 2265 E. Hathaway Road, Harbor Springs, MI 49740	

EMMET COUNTY ROAD COMMISSION
 IN COOPERATION WITH
 CRA & EGLE

CROSS-SECTION VIEW
 VAN CREEK

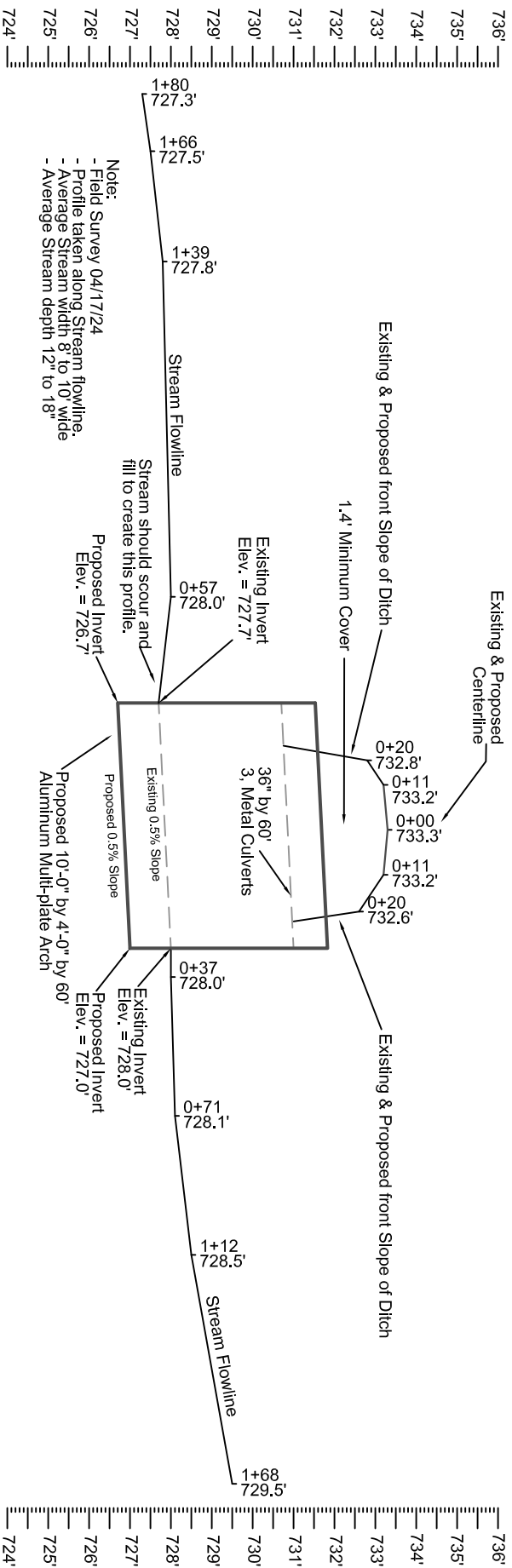

PROJECT DESCRIPTION
 PROPOSED CULVERT REPLACEMENT VAN ROAD AND
 VAN CREEK

VAN ROAD AT VAN CREEK
 SEC. 15, T37N, R34W, ANKENIETWP,
 EMMET COUNTY, MICHIGAN

DATE: 06/17/24
 DRAWN BY: TLH.

APPLICANT:
 EMMET COUNTY ROAD COMMISSION

2265 E. Hathaway Road, Harbor Springs, MI 49740

Andrew Jackson Blackbird was born in the L'Arbre Croche area of Michigan (now Harbor Springs) around 1815. At least one account, though, places this date as late as 1821. His father was an Ottawa chief named Mack-e-te-be-nessy (Makadebinesi, "black hawk"). The name was mistranslated first by the French and from French to English as "Blackbird", which became the family's English name. Mack-e-te-be-nessy was chief of the Arbor Croche or Middle Village band. Mack-e-te-be-nessy was stranded on a small island by white traders he was helping, and was left to die. Although his father survived, this cruelty left a strong impression on his son. The death of his brother, William, in Rome, Italy on June 25, 1833, under suspicious circumstances as he was completing his studies for the Roman Catholic priesthood, left an indelible impression on Andrew and perhaps was the source of his intense antipathy for that religion from then on. Blackbird frequently bemoaned his limited formal education. Because his father was a chief, Blackbird was solidly educated in traditional Ottawa culture and practices. Blackbird was baptized a Roman Catholic by a priest called Father Baden in 1825, but later converted to Protestantism. He served as interpreter at the Protestant mission in L'Arbre Croche. Even though he was a Christian, he knew the traditional Ottawa religious beliefs well.

www.wikipedia.org

McKINLEY T37N • R4W

Copyright © 2013 Mapping Solutions

SEE PAGE 15

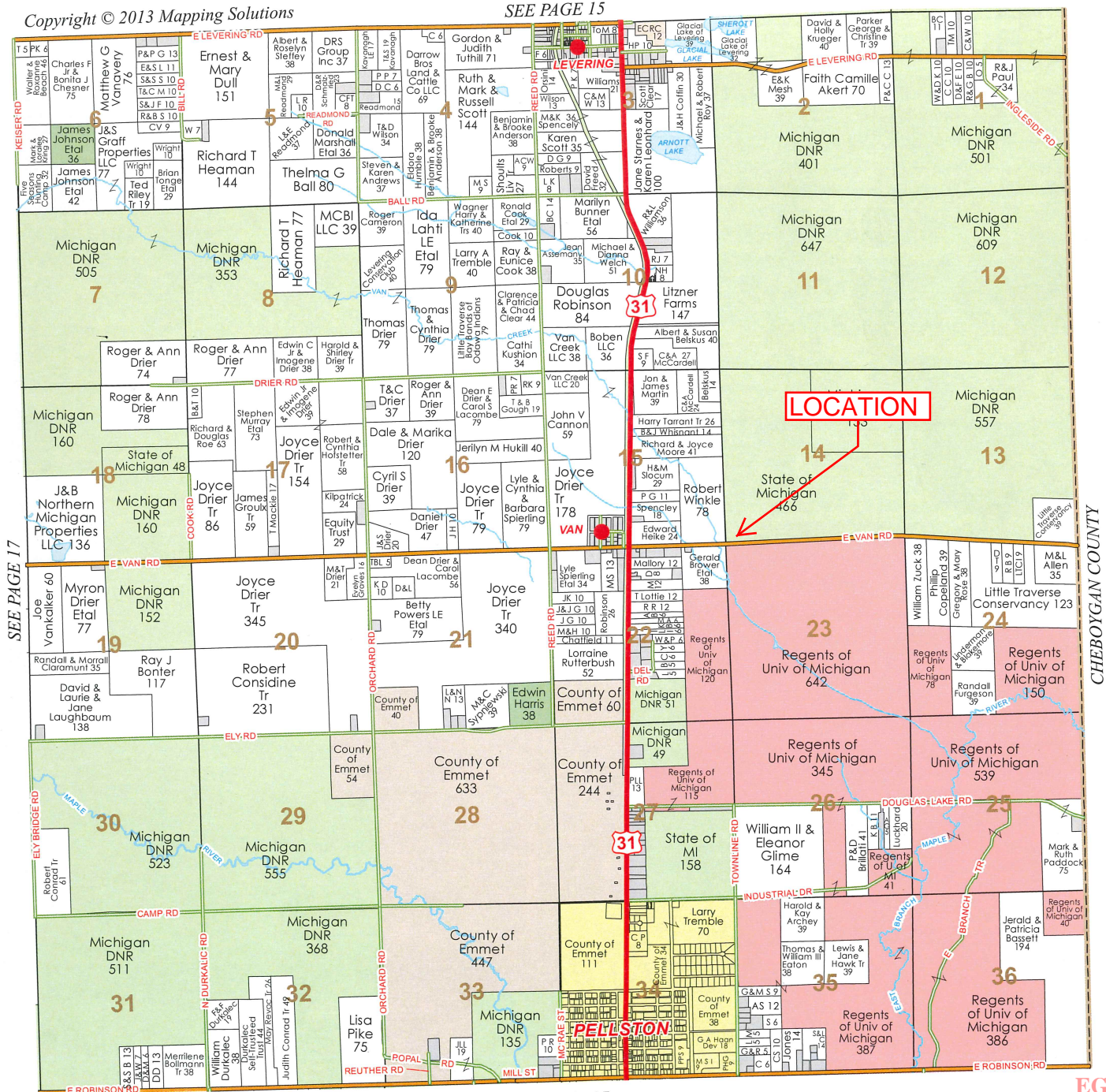

6000
5500
5000
4500
4000
3500
3000
2500
2000
1500
1000
500

SEE PAGE 17

CHEBOYGAN COUNTY

SEE PAGE 27

3000 3500 4000 4500 5000 5500 6000 6500 7000 7500 8000 8500 9000

EGLE
WRP041632 v1.0
Approved
Issued On: 06/11/2024
Expires On: 06/11/2029